

NIDA System Ceiling quadruple lining  
Single frame with Adjustable Bracket  
Rigid fixing with massive element  
Cross Section

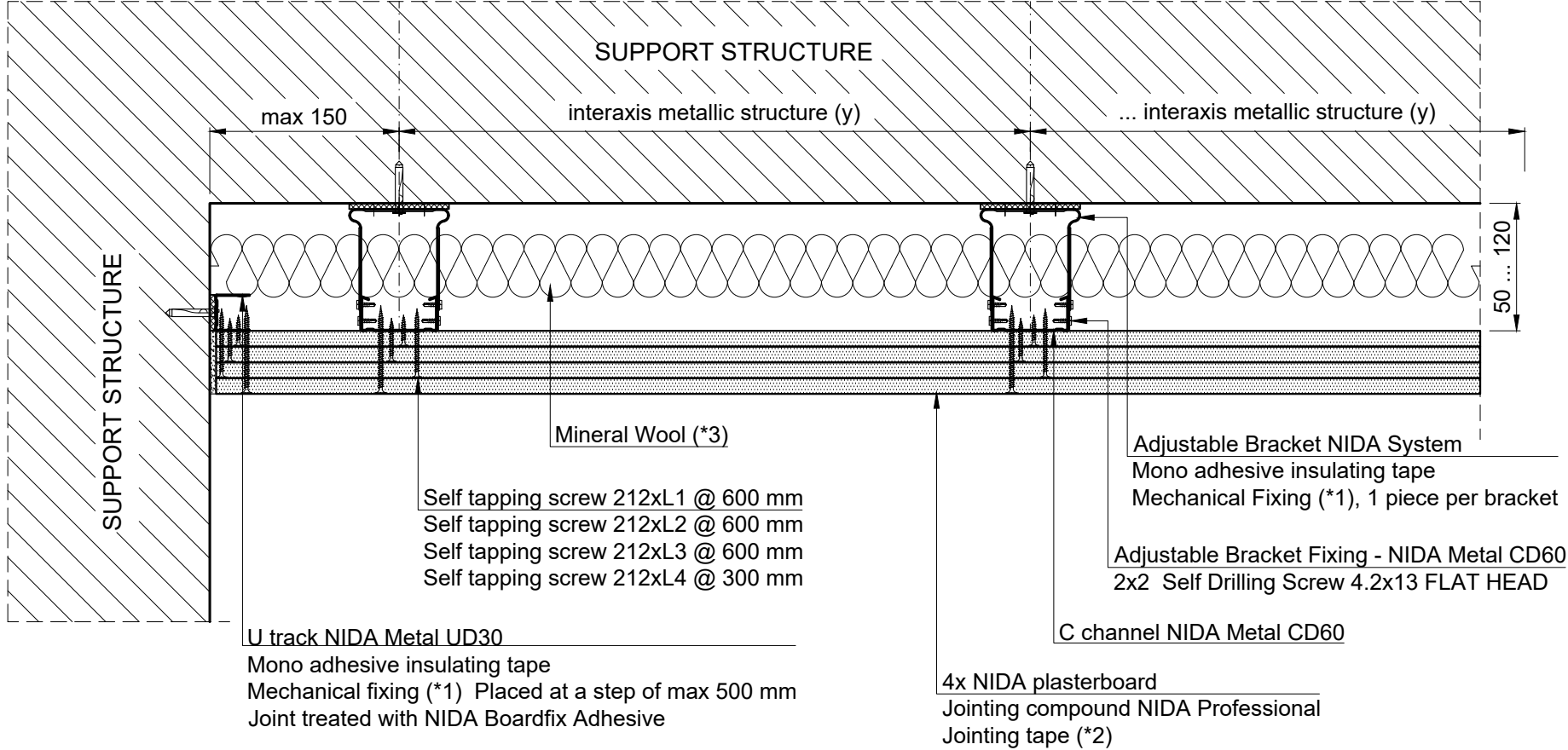

The technical details presented in this documentation represent System Type details, their adaptation to the project will be done by the specialised designer of the building in collaboration with the SINIAT technical department.

NIDA System P

Chapter title: NIDA System Ceiling quadruple lining. Simple frame with Adjustable Bracket			
Subchapter title: Rigid fixing with massive elements. Cross Section			
Drawing no: P4.S1.Br.001	Edition no: 1	Scale: 1:5	Date: 2019



NIDA System Ceiling quadruple lining  
Single frame with Adjustable Bracket  
Sliding fixing with massive elements  
Cross Section

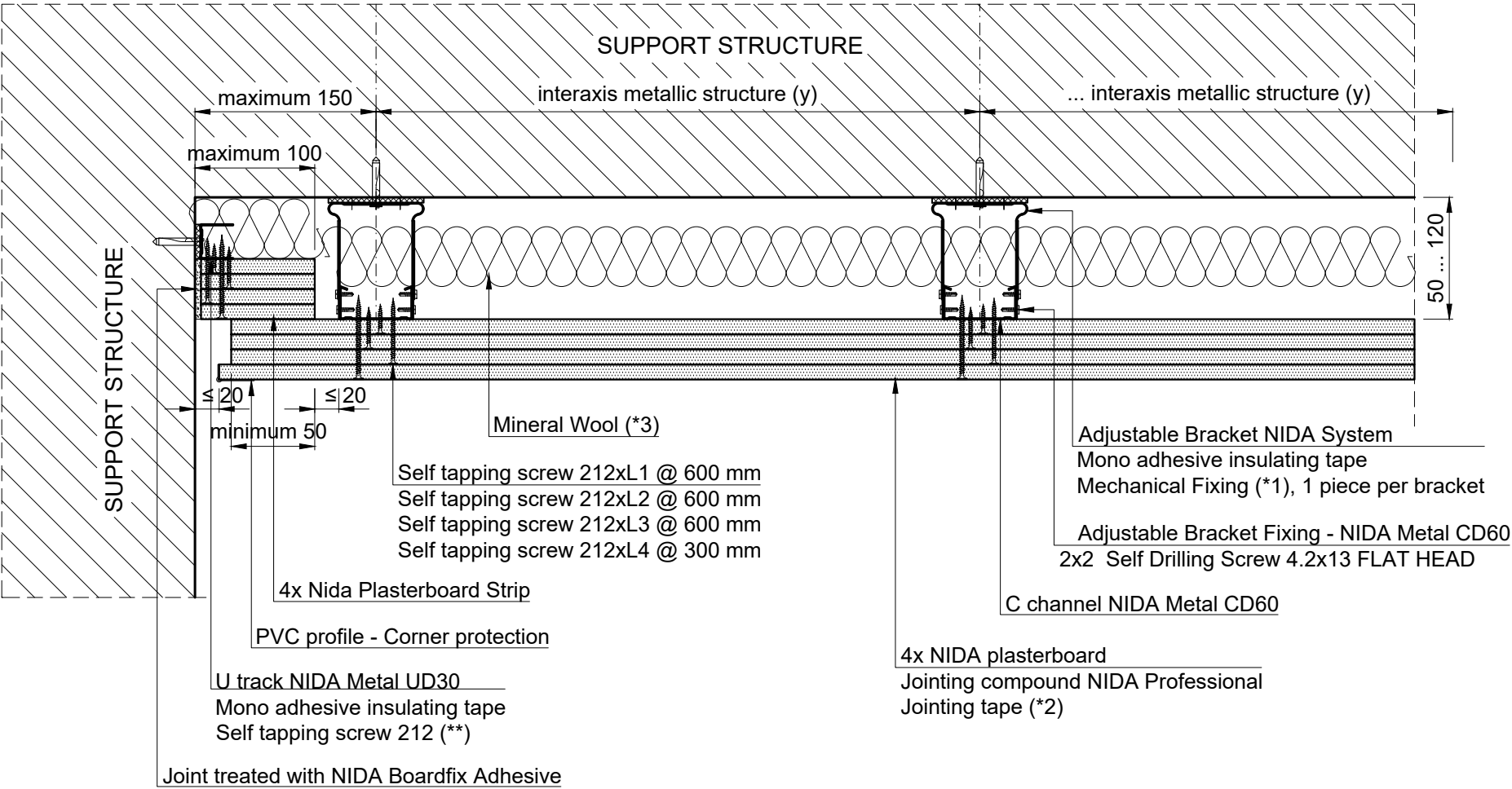

The technical details presented in this documentation represent System Type details, their adaptation to the project will be done by the specialised designer of the building in collaboration with the SINIAT technical department.

NIDA System P

Chapter title: NIDA System Ceiling quadruple lining. Simple frame with Adjustable Bracket			
Subchapter title: Sliding fixing with massive elements. Cross Section			
Drawing no: P4.S1.Br.002	Edition no: 1	Scale: 1:5	Date: 2019



NIDA System Ceiling quadruple lining  
Single frame with Adjustable Bracket  
Rigid fixing with massive element  
Longitudinal Section

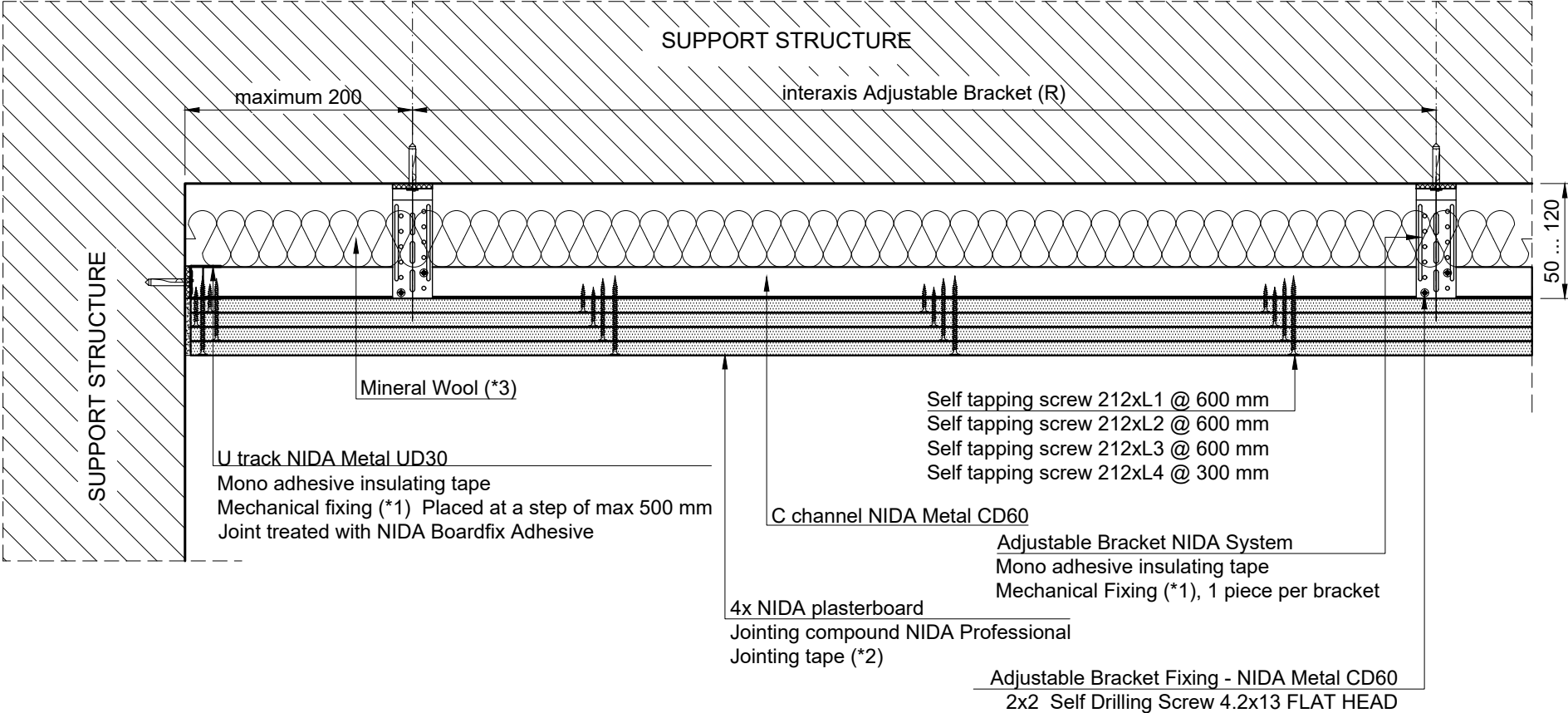

The technical details presented in this documentation represent System Type details, their adaptation to the project will be done by the specialised designer of the building in collaboration with the SINIAT technical department.

### NIDA System P

Chapter title: NIDA System Ceiling quadruple lining. Simple frame with Adjustable Bracket			
Subchapter title: Rigid fixing with massive elements. Longitudinal Section			
Drawing no: P4.S1.Br.003	Edition no: 1	Scale: 1:5	Date: 2019



NIDA System Ceiling quadruple lining  
 Single frame with Adjustable Bracket  
 Sliding fixing with massive elements  
 Longitudinal Section

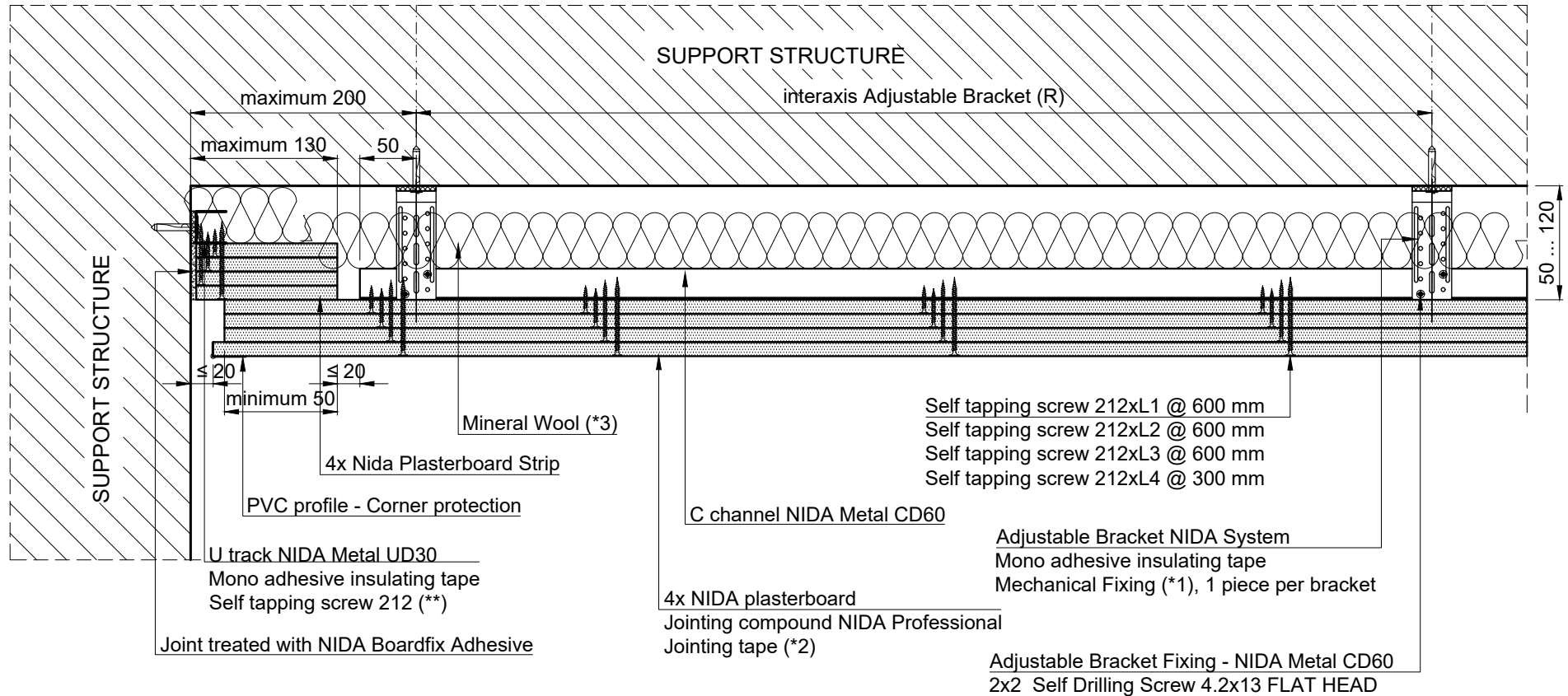

The technical details presented in this documentation represent System Type details, their adaptation to the project will be done by the specialised designer of the building in collaboration with the SINIAT technical department.

NIDA System P			
Chapter title: NIDA System Ceiling quadruple lining. Simple frame with Adjustable Bracket			
Subchapter title: Sliding fixing with massive elements.Longitudinal Section			
Drawing no: P4.S1.Br.004	Edition no: 1	Scale: 1:5	Date: 2019



NIDA System Ceiling quadruple lining  
Single frame with Adjustable Bracket  
Intersection with Plasterboard Wall Partition  
Cross Section

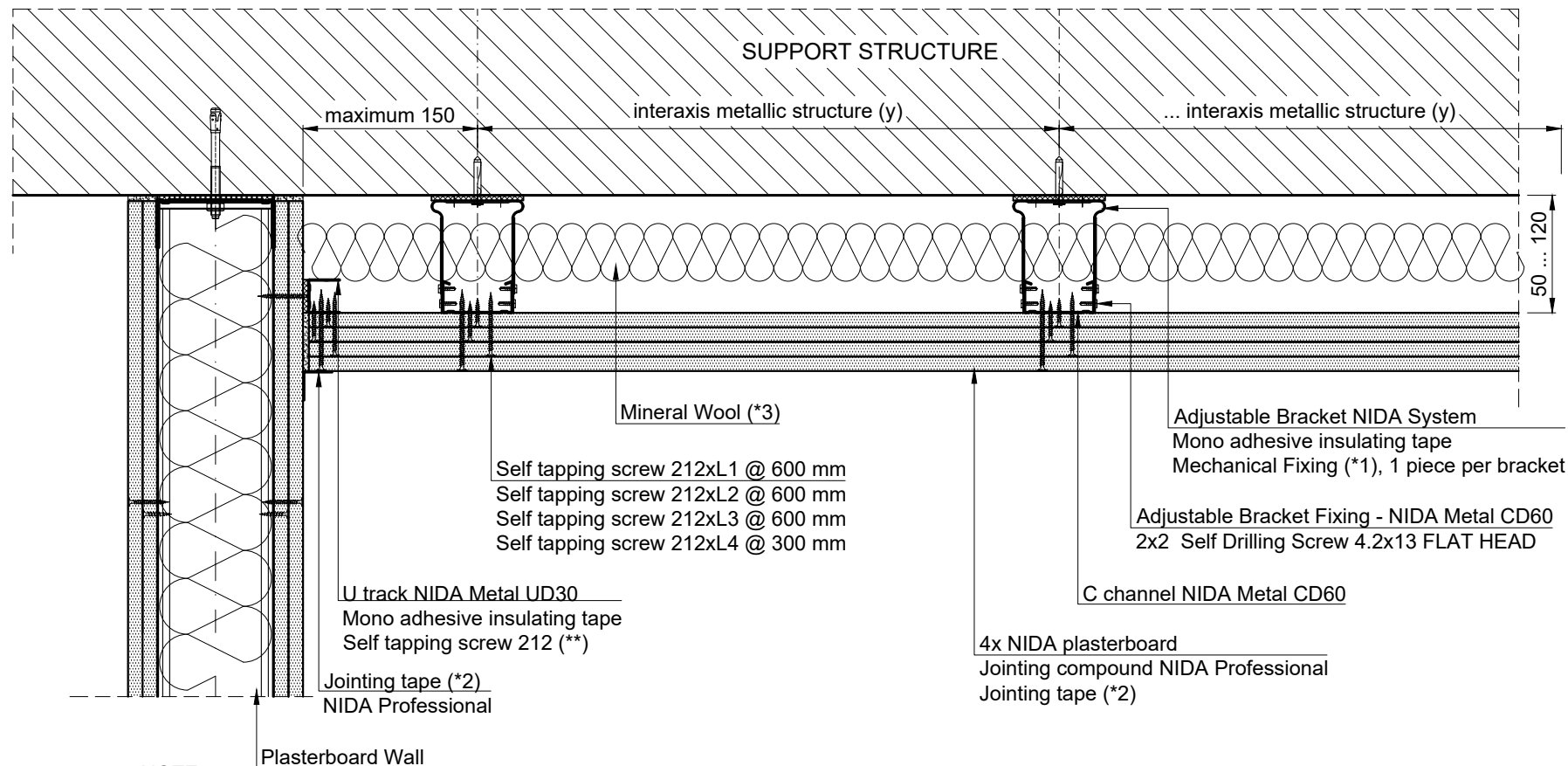

NOTE:

(\*\*) The self tapping screw shall be fixed on the metal structure of the Plasterboard Wall, the lenght of the screw will be according to the thickness of the fixing package (Wall boards thikness of layers)

The technical details presented in this documentation represent System Type details, their adaptation to the project will be done by the specialised designer of the building in collaboration with the SINIAT technical department.

NIDA System P

Chapter title: NIDA System Ceiling quadruple lining. Simple frame with Adjustable Bracket			
Subchapter title: Intersection with Plasterboard Wall Partition. Cross Section			
Drawing no: P4.S1.Br.005	Edition no: 1	Scale: 1:5	Date: 2019



NIDA System Ceiling quadruple lining  
Single frame with Adjustable Bracket  
Intersection with Dry Wall Partition  
Longitudinal Section

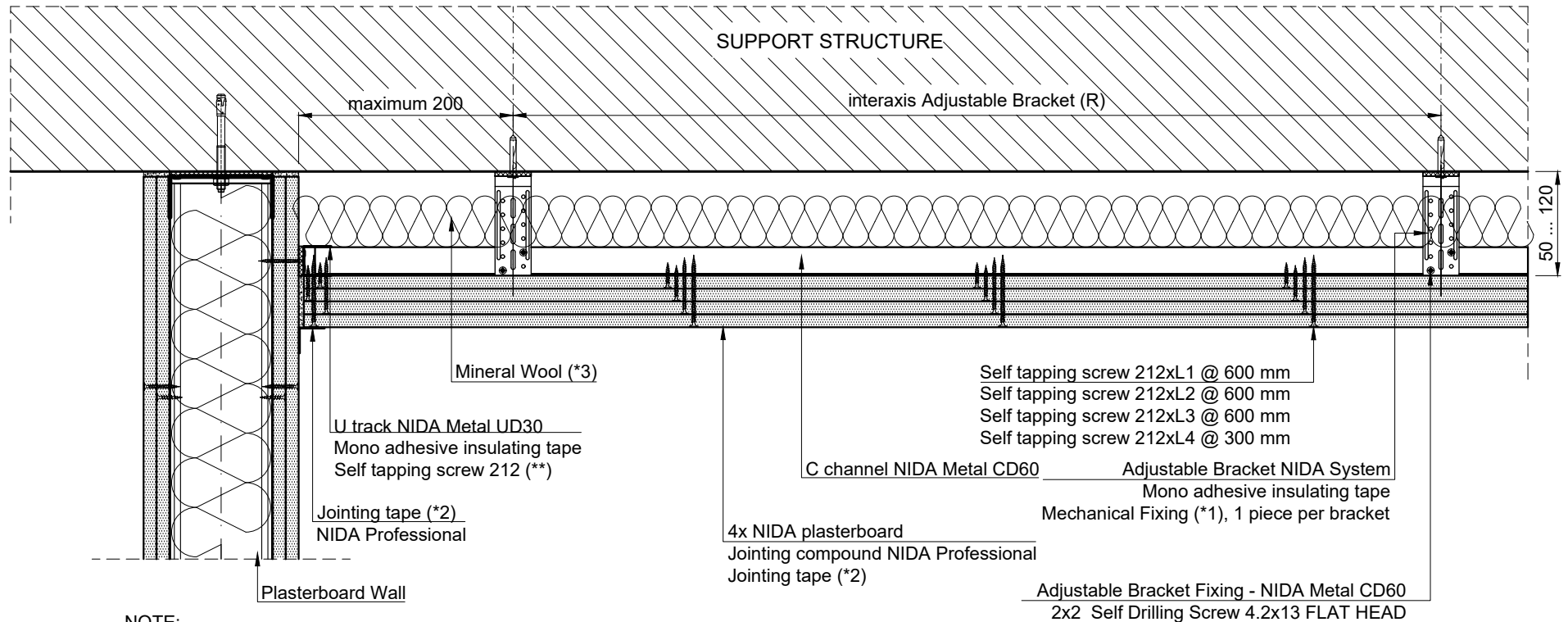

NOTE:

(\*\*) The self tapping screw shall be fixed on the metal structure of the Plasterboard Wall, the length of the screw will be according to the thickness of the fixing package (Wall boards thickness of layers)

The technical details presented in this documentation represent System Type details, their adaptation to the project will be done by the specialised designer of the building in collaboration with the SINIAT technical department.

NIDA System P

Chapter title: NIDA System Ceiling quadruple lining. Simple frame with Adjustable Bracket			
Subchapter title: Intersection with Plasterboard Wall Partition. Longitudinal section			
Drawing no: P4.S1.Br.006	Edition no: 1	Scale: 1:5	Date: 2019



NIDA System Ceiling quadruple lining  
Single frame with Adjustable Bracket  
Expansion joint  
Cross Section

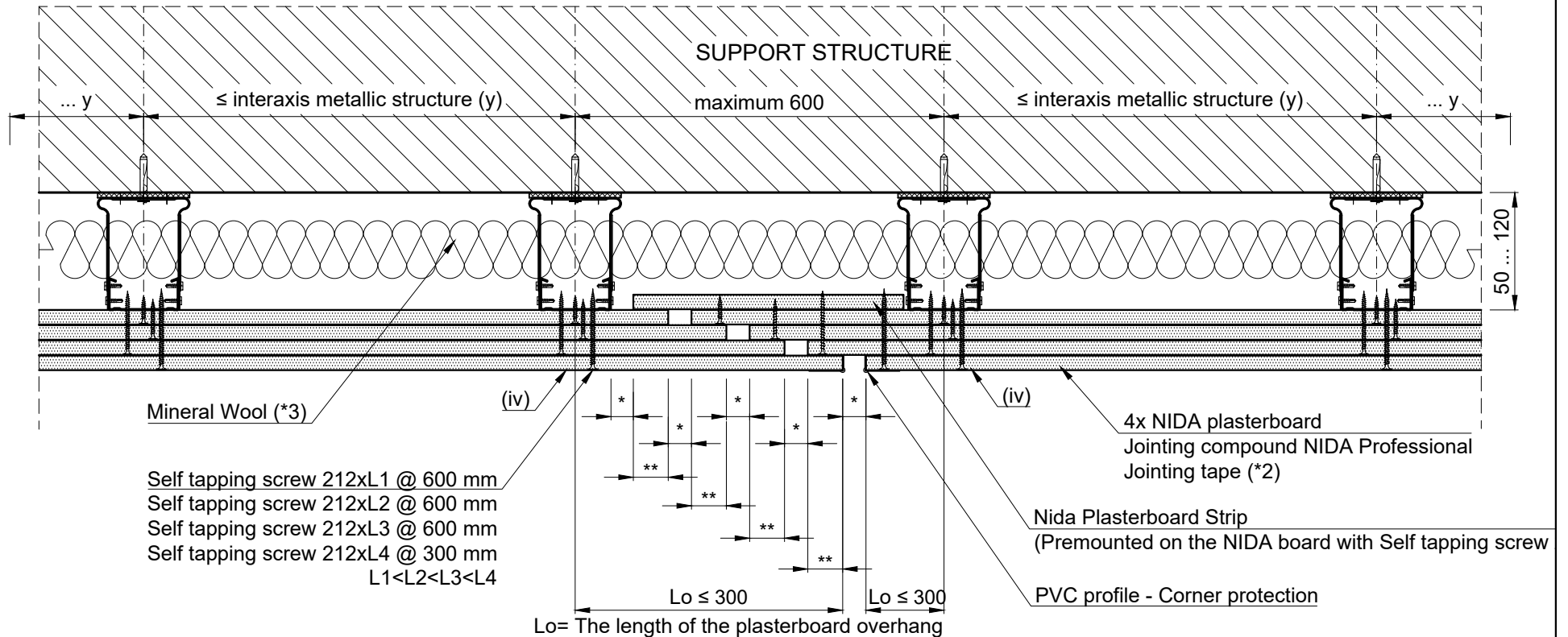

NOTE:

- (iv) For the last row of plasterboards joints shall not be made in the indicated area;  
The joint shall also be placed right to the structural joints;
- \* The size of the joint's gap will be established considering the size of the structural joint's gap but not less than 20 mm;
- \*\* Boards overlap shall have a value of minimum (\* + 10 mm)

The technical details presented in this documentation represent System Type details, their adaptation to the project will be done by the specialised designer of the building in collaboration with the SINIAT technical department.

NIDA System P

Chapter title: NIDA System Ceiling quadruple lining. Simple frame with Adjustable Bracket			
Subchapter title: Expansion joint. Cross Section			
Drawing no: P4.S1.Br.007	Edition no: 1	Scale: 1:5	Date: 2019



NIDA System Ceiling quadruple lining  
Single frame with Adjustable Bracket  
Expansion joint  
Longitudinal Section

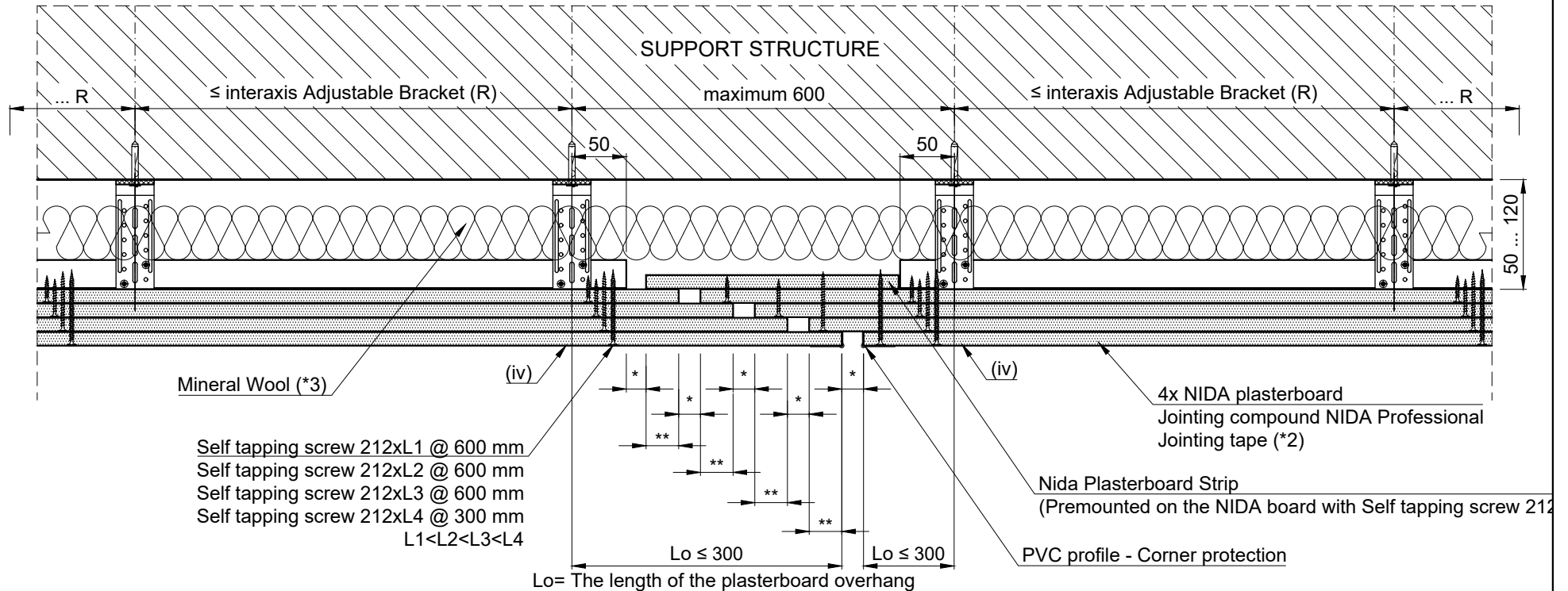

NOTE:

- (iv) For the last row of plasterboards joints shall not be made in the indicated area;  
The joint shall also be placed right to the structural joints;
- \* The size of the joint's gap will be established considering the size of the structural joint's gap but not less than 20 mm;
- \*\* Boards overlap shall have a value of minimum (\* + 10 mm)

The technical details presented in this documentation represent System Type details, their adaptation to the project will be done by the specialised designer of the building in collaboration with the SINIAT technical department.

NIDA System P

Chapter title: NIDA System Ceiling quadruple lining. Simple frame with Adjustable Bracket			
Subchapter title: Expansion joint. Longitudinal Section			
Drawing no: P4.S1.Br.008	Edition no: 1	Scale: 1:5	Date: 2019





## Jointing Detail NIDA Metal CD60 Profile

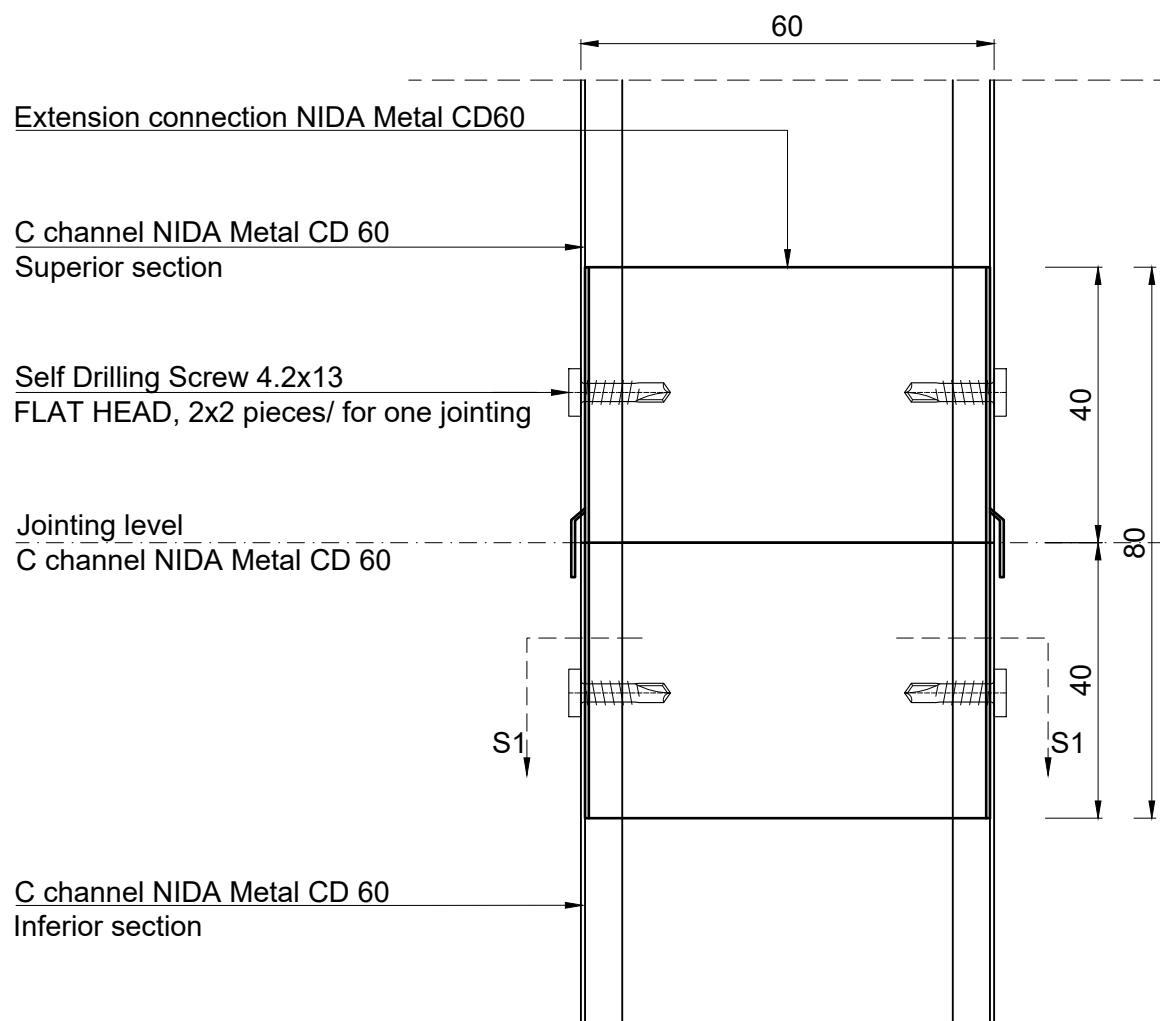

### Section S1-S1

Self Drilling Screw 4.2x13  
FLAT HEAD, 2x2 pieces/ for one jointing

C channel NIDA Metal CD 60

Extension connection NIDA Metal CD 60

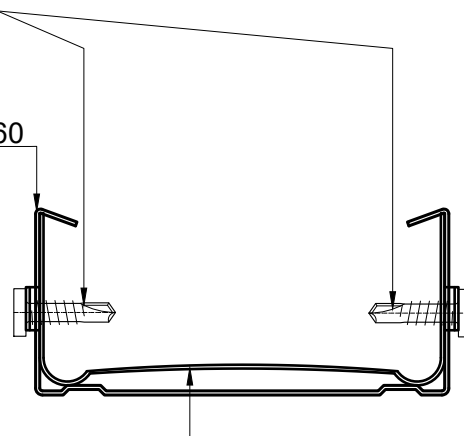

The technical details presented in this documentation represent System Type details, their adaptation to the project will be done by the specialised designer of the building in collaboration with the SINIAT technical department.

NIDA System P

Chapter title:  
NIDA System Ceiling quadruple lining. Simple frame with Adjustable Bracket

Subchapter title:  
Jointing Detail NIDA Metal CD60 Profile

Drawing no:	Edition no:	Scale:	Date:
P4.S1.Br.009	1	1:5	2019



# Boards staggering System elevation

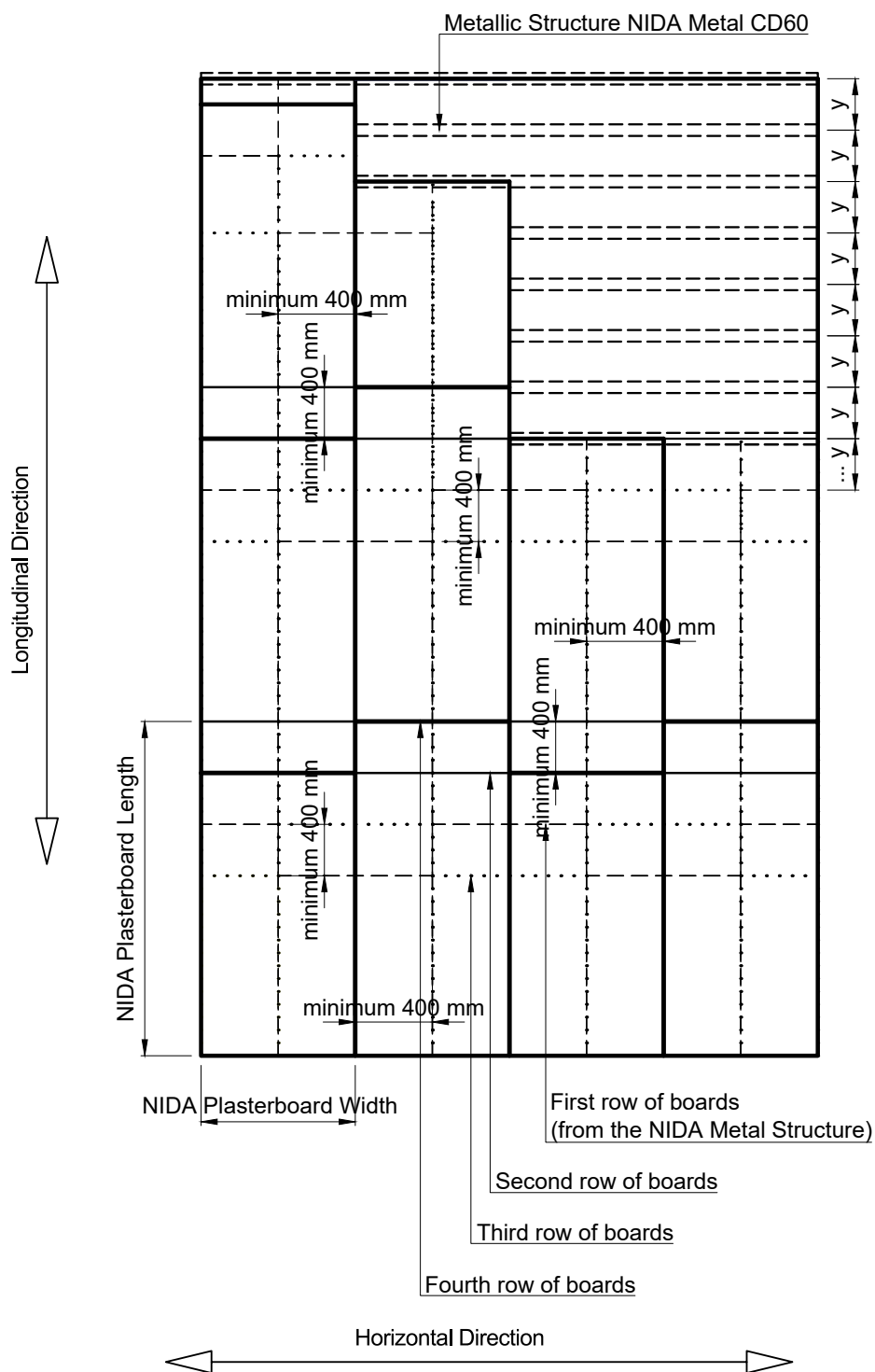

Boards are fixed perpendicular on Nida Metal CD60 profiles.  
Boards staggering on longitudinal direction is minimum 400 mm.

The technical details presented in this documentation represent System Type details, their adaptation to the project will be done by the specialised designer of the building in collaboration with the SINIAT technical department.

## NIDA System P

Chapter title:  
NIDA System Ceiling quadruple lining. Simple frame with Adjustable Bracket

Subchapter title:  
Boards staggering. System elevation

Drawing no:	Edition no:	Scale:	Date:
P4.S1.Br.010	1	1:5	2019

